

USER INSTRUCTION MANUAL

optiva



OptivaV-0800
OptivaVX-0800



OptivaV-0868
OptivaVX-0868

Operating Principles

As soon as you strike an arc, your new welding filter will automatically darken. There are no switches to worry about. Our advanced optical detection system monitors your welding process to ensure that your filter remains in the dark state in a wide range of arc welding applications. Protection from harmful ultra-violet / infrared radiation is always present whether in the light or dark shade.

There is no need to turn on your new auto-darkening filter. There is never a battery to change. There will never be any corrosion caused by leaky batteries, which is found in some other brands of auto-darkening filters. Your new product is solar powered with permanent rechargeable battery back up, to ensure delay free functionality, even when in total darkness. Since the battery constantly receives a trickle charge you will enjoy years of reliable trouble free operation. **Note: Unless you plan on using your filter frequently, we suggest that when your filter is not in use, store it near a window or other light source (solar panels to the light source) to ensure the back up battery is fully charged. If the back-up battery runs down you may notice that the changing speed is not at its optimum.**

Your new filter is capable of working in virtually all arc-welding environments. It is not recommended for use for oxy-acetylene, laser, or very low amperage welding applications. It is impossible to be specific as to the exact amperage as every welding application is different and other contributing factors may effect operation such as: distance from the arc, electrodes, shielding gasses, and lighting conditions, just to name a few.

Preparations for Use

Before you begin welding always inspect your helmet and filter to ensure they are not damaged. Check to see if the filter protection plates are clean, clear, and securely attached to the helmet and auto-darkening filter both front and rear.

WARNING, never begin welding without first checking to see if the correct front and rear protection plates are in place. (See table III for part numbers) Failure to protect your welding filter may cause damage and subsequently a safety hazard should the UV/IR protection become compromised by spatter damage or cracking from impact. Resulting damage will not be covered by warranty.

Preparations for Use: (continued)

Place the helmet on your head, push in and turn the adjusting knob to ensure a comfortable fit. The ratchet headgear is designed to lock in place when released. To test your auto-darkening filter, prior to striking an arc, direct the front of the filter to a bright source of light and simply run your finger quickly over the sensor. The filter should darken momentarily then switch back to the light state. Avoid blocking the solar panels. You're now ready to begin welding.

WARNING, other safety precautions such as protective clothing, adequate ventilation, breathing protection, such as a Compact Air PAPR or equal, fire extinguisher, and protection for co-workers in the immediate area should be considered.

Maintenance

Your new filter requires virtually no maintenance other than periodic cleaning if the lens becomes clouded from smoke. Filters may be cleaned by using a soft, non-abrasive, dry or damp cloth. Be sure that the cloth you use is clean. Abrasive particles in the cloth could scratch the highly polished lens surface. Additional front and rear cover plates are available from your **OPTIVA** distributor. See Table I and for part numbers. **NOTE, using the wrong cover plates may damage your product and void warranty.**

Technical Information

The 2000V & 2000VX is a variable shade welding helmet. This means that, when in the dark state, the darkness can be adjusted from the lightest dark shade to the darkest. Typically the higher the welding amperage the darker the shade. This feature allows the user to utilize one welding filter in many applications and amp ranges with comfort and safety. A knob located on the outside of the helmet can be rotated to decrease or increase the shade level between shades 9 and 13. See Table II for filter specifications.

All electronic welding filters exhibit a characteristic known as angle dependency. The lens may appear to be somewhat darker in the center and lighter toward the outer edges or when the lens is viewed at an angle not perpendicular to the welding arc. Contact the **OPTIVA Customer Service at 866-814-9919** for additional information regarding angle dependency.

Grind Mode: 2000VX - Press and hold grinding button until the LCD flickers to indicate the change to grind mode. Press (DO NOT HOLD) again to turn off (LCD will not flicker).

OPTIVA auto-darkening filters protect the user against harmful ultra-violet / infrared (UV/IR) rays, both in the dark and light state. No matter what shade the filter is set to, the UV/IR protection is there. You can never burn your eyes due to optical radiation passing through our filter. The users eyes can be severely burned if he welds with a damaged lens (cracked, pitted, etc.) or optical radiation can possibly enter in from behind as a result of other welders in the immediate area.

ANSI defines all welding helmets as secondary protection from optical radiation and impact. For complete safety, primary protection, such as spectacles or goggles, should be used in conjunction with welding helmets. Protective clothing and accessories such as leather bibs attached to the welding helmet will protect the user from spatter and optical radiation indirectly entering from areas behind the helmet.

Please remember that Welding Helmets provide a secondary level of safety protection and should be used in conjunction with a primary protection device such as approved safety glasses (spectacles).

The OPTIVA has been designed to accept an additional protective lens. This additional lens installs immediately in front of the auto-darkening filter and behind the outer polycarbonate clear lens thus adding an even greater level of spatter protection.

Part Numbers for Intermediate Cover Plates

Helmet Model
OPTIVA 2000V

Part No.
04-OP

Part Selection Guide (Table I)

Part Numbers	Descriptions
2-0800	Legend Helmet Replacement
Optiva-9/13	Optiva Replacement Filter
04-OP	Inside/Intermediate/Outside Polycarbonate
SS2-KA	Potentiometer Knob
04-HGSB	Headgear sweat band
01-HGA	Headgear assembly.
01-HG	Ratchet headgear

SPECIFICATIONS (Table II) Auto-darkening Filters

	Optiva-2000V	Optiva-2000VX
Viewing Area	3290mm	3290mm
Filter Dimensions	110mm x 90mm	110mm x 90mm
Grinding Mode	No	Yes
Filter Weight	3.2 ounces	3.2 ounces
Switching Time Seconds	5/10000 (0.5 milliseconds)	5/10000 (0.5 milliseconds)
Power Supply Primary	Solar Cells	Solar Cells
Power Supply Back-up	Rechargeable Battery	Rechargeable Battery
Operating / Storage Temperature	14 to 148 degrees F	14 to 148 degrees F
UV / IR Protection Light or dark	Up To Shade 16	Up To Shade 16
Dark to Light Delay (Seconds)	0.1 seconds	0.1 or 2 seconds
Light Shades Available	4	4
Dark Shade Available	9-13	9-13
Certification (pending)	ANSI Z87,1 - 1989	ANSI Z87,1 - 1989

Helmet Assembly

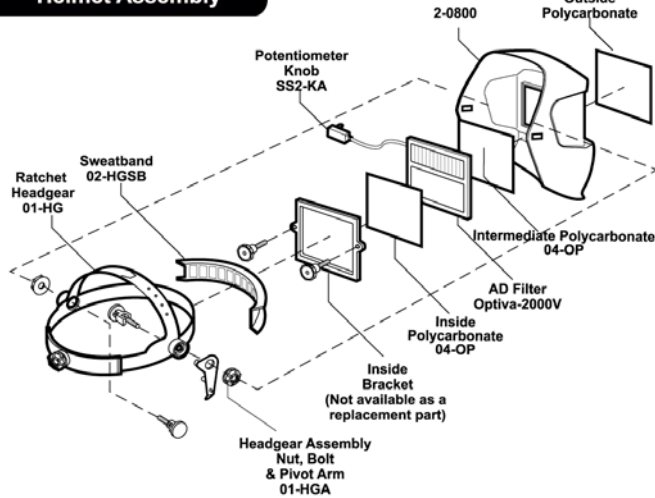

Warranty and Service Information

LIMITED WARRANTY

I. The **OPTIVA-2000V** is warranted for one (1) year from the date of purchase against manufacturing defects resulting from materials or workmanship. **Proof of purchase establishing the date of sale and filter serial number must be provided, should a warranty claim be submitted.** The purchaser's only remedy under this limited warranty shall be limited to **OPTIVA'S** sole option to repair, replace or refund (not to exceed the purchase price). This limited warranty is void in the case of unauthorized modification, tampering, or damage due to misuse, abuse, inadequate maintenance, or improper storage. This limited warranty is not transferable from the original purchaser to a secondary owner. **OPTIVA** shall in no event be liable or responsible for any injury, damage, or loss resulting either directly or indirectly from the use or misuse of this product. This limited warranty is exclusive and is in lieu of any other warranty implied either oral or written. Please read the instruction manual carefully to avoid certain situations which may void this limited warranty.

II. In the unlikely event that the auto-darkening filter malfunctions, the following procedures are to be used to receive efficient service and repair:

Determine if the product is damaged from abuse or misuse. Any pitted marks on the filter possibly from spatter, chips or dents, or cracks, etc., are some indications of operator abuse. In the case of operator abuse, the warranty is void.

For warranty or non-warranty repairs or replacements please proceed as follows:

Please Do not contact the distributor or retailer from whom you purchased the filter

1. Contact **OPTIVA Customer Service** (866-814-9919) for a Service Tag Number.
2. Send only the auto-darkening filter, freight prepaid, directly to the **OPTIVA Service Center, 85 Independence Drive, Taunton, MA. 02780**. Reference your assigned Service Tag Number on the outside of the package and on all accompanying paperwork.
3. Provide a brief description of the problem. Provide return shipping information. Complete information will help to expedite the process.
4. Visa, MasterCard, or checks are the only forms of payment accepted. In the case of credit cards include credit card number expiration date, the full name as it appears on the card, and your signature as authorization for the total repair amount.
5. All returns, which follow the above procedures, will be processed within 2 business days.
6. All warranty repairs are covered for the balance of the original warranty period.
7. All non-warranty repairs carry a 90-day, limited warranty.

OPTIVA™ is a Division of A. C. E. International Company
85 Independence Drive,
Myles Standish Park, Taunton, MA 02780
Tel: (866-814-9919)